

Killeen Business / Industrial Park

As of September 2008

- Available
- Unavailable

Price Guide

- AA** \$2 sq. ft. or \$87,120 / acre
- A** \$1 sq. ft. or \$43,560 / acre
- B** \$35,000 / acre
- C** \$21,000 / acre
- D** Less than \$21,000 / acre

Lot 1, Block 1 in Available Section of the Killeen Business Park is Phase VI and is separate from Sallie Mae description

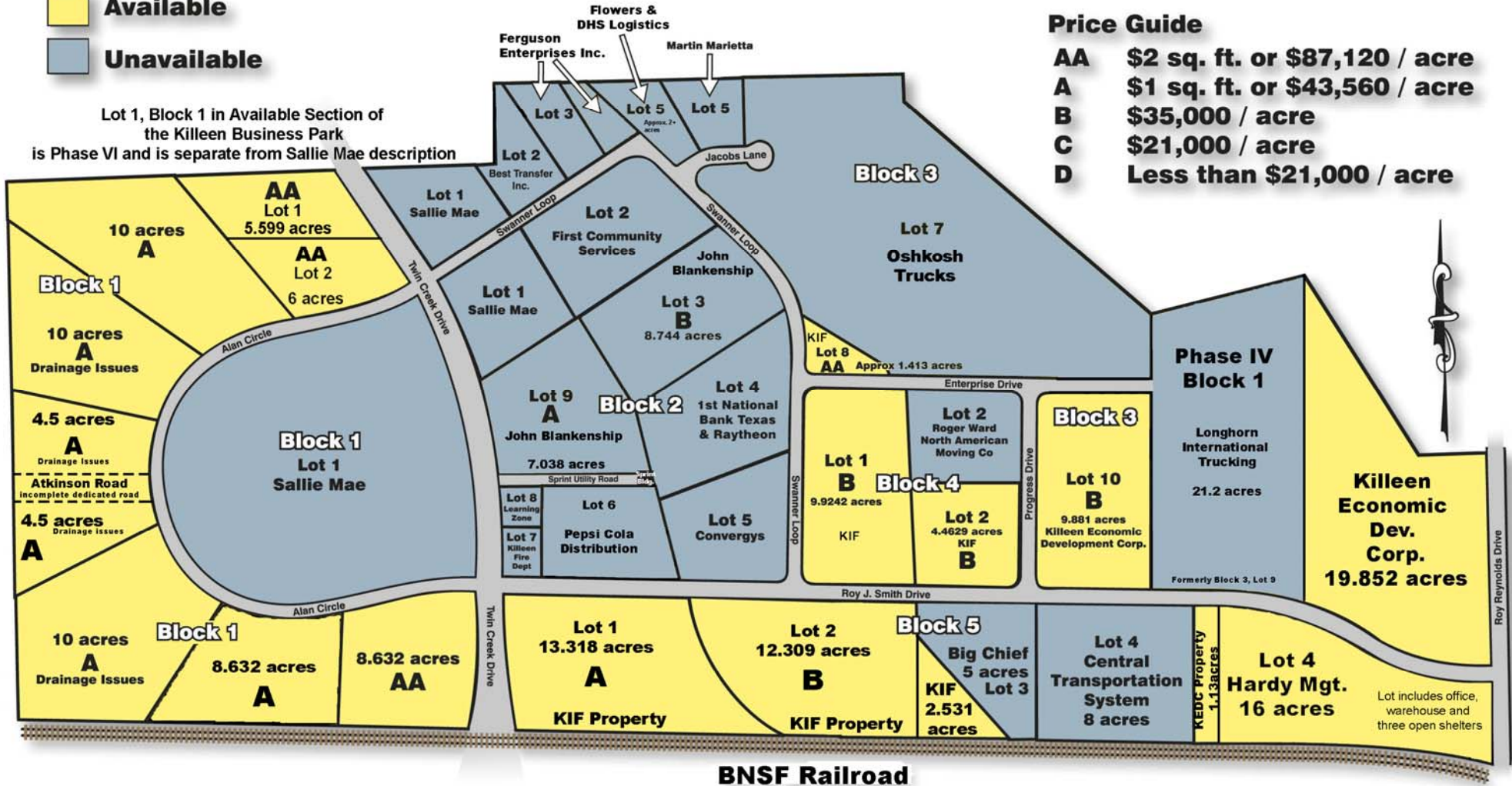

BNSF Railroad

For more information about the Killeen Business/Industrial Park, call the chamber at (800) 869-8265 or via email at pgogue@gkcc.com